

GPPOC (PN-EN 10230-1) Roofing nails with washers

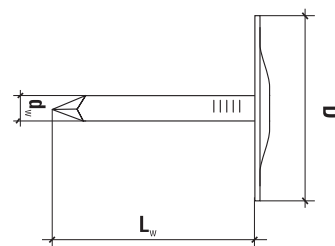

Description

- Application** For attaching insulation building paper, thin steel sheets and roof work elements to wooden load-bearing structures.
- Installation** Does not require prior drilling.
- Substrate** Chipboard, plywood, wood, sterling board, MDF board
- Material** Galvanized low-carbon steel

| Code | $d_w \times L_w$ [mm] | D [mm] | kg |
|-------------|-----------------------|--------|----|
| GPPOC-28025 | 2,8 x 25 | 30 | 5 |
| GPPOC-28028 | 2,8 x 28 | 30 | 5 |
| GPPOC-28038 | 2,8 x 38 | 30 | 5 |

GPSOC (PN-EN 10230-1) High torsion strength roofing nails

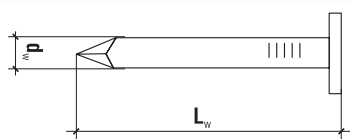

Description

- Application** Nails for attaching insulation building paper, thin steel sheets and roof work elements to wooden load-bearing structures. The nails have a flat widened head and twisted pin which helps to fix them firmly in the substrate and thus resist the tension force.
- Installation** Does not require prior drilling.
- Substrate** Chipboard, plywood, wood, sterling board, MDF board
- Material** Blck finish or galvanized low-carbon steel

| Code | $d_w \times L_w$ [mm] | kg |
|-------------|-----------------------|----|
| GPSOC-30025 | 3,0 x 25 | 5 |
| GPSOC-30030 | 3,0 x 30 | 5 |
| GPSOC-30035 | 3,0 x 35 | 5 |

GHWOC Hardened grooved nails

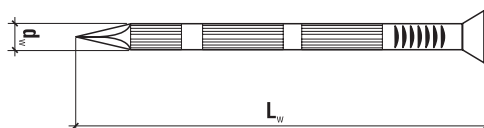

Description

- Application** Used for lap joining and fixing of woodwork to hard member like concrete, brick, aerated and cellular concrete.
- Installation** Does not require prior drilling.
- Substrate** Chipboard, plywood, wood, sterling board, MDF board
- Material** Galvanized low-carbon steel

| Code | $d_w \times L_w$ [mm] | Size in inches | kg |
|-------------|-----------------------|----------------|----|
| GHWOC-27025 | 2,7 x 25 | 1" | 3 |
| GHWOC-27030 | 2,7 x 30 | - | 3 |
| GHWOC-27035 | 2,7 x 35 | - | 3 |
| GHWOC-27040 | 2,7 x 40 | 1,5" | 3 |
| GHWOC-35045 | 3,5 x 45 | - | 3 |
| GHWOC-35050 | 3,5 x 50 | 2" | 3 |
| GHWOC-35060 | 3,5 x 60 | - | 3 |
| GHWOC-35065 | 3,5 x 65 | 2,5" | 3 |
| GHWOC-45070 | 4,5 x 70 | - | 3 |
| GHWOC-45080 | 4,5 x 80 | 3" | 3 |