

**KPS-FAST 8 K**

Frame plug Ø8 with hex head screw  
**ZINC PLATED SCREW**

**KPS-FAST 8 K A4**

Frame plug Ø8 with hex head screw  
**A4 STEEL SCREW**

**KPS-FAST 8 K 00**

Frame plug Ø8 with hex head screw  
**HOT-DIP GALVANIZED SCREW**



**NEW!**

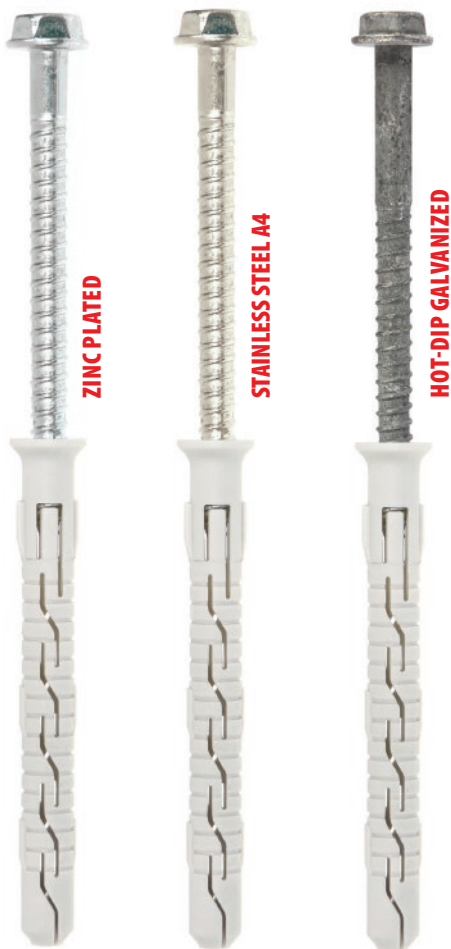

Description

Frame plug with flanged hex head screw for fixing of metal members

Technical data

Type of installation	push-through installation
Substrate	concrete, solid clay brick, perforated clay brick, autoclaved aerated concrete

Sleeve material / Protective coating



Features and advantages of the product



**Hex head with TX-30/SW-10 drive**

TX drive ensures optimum transfer of torque while SW-10 hex head allows for tightening the screw with a given force (e.g. with torque wrench).



**Reduced thread**

Precise installation of the screw  
Increased expansion force in the second expansion zone.



Installation

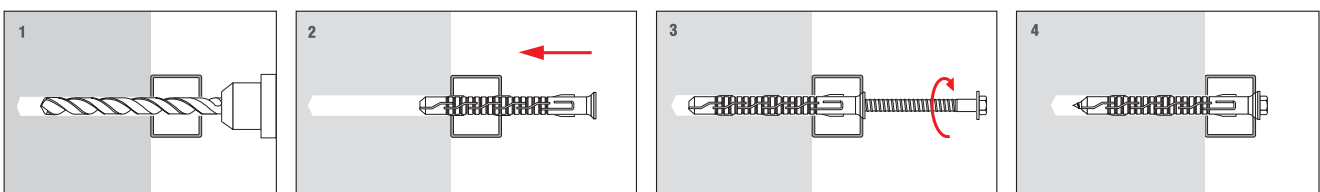

### TECHNICAL DATA

Product marking

<b>KPS-FAST</b>	<b>08</b>	<b>080</b>	<b>K</b>	<b>00</b>
Type	Diameter	Length	Head type	Type of steel and coating

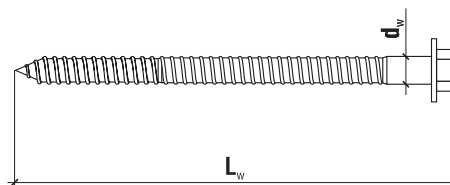
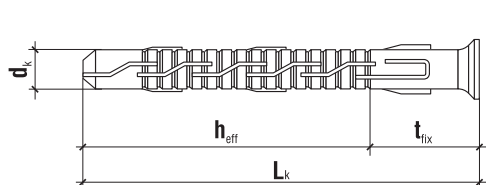

SW-10  
TX-30

Ø	Code BLUE ZINC PLATED	Code A4 STAINLESS STEEL	Code HOT-DIP GALVANIZED	$d_k \times L_k$ [mm]	$d_w \times L_w$ [mm]	Max. fixture thickness $t_{fix}$ [mm]	Drive type		Pcs
08	KPS-FAST-08080K	KPS-FAST-08080K-A4	KPS-FAST-08080K-00	8.0 x 80	6.0 x 85	10*/30**	TX-30	SW-10	50
	KPS-FAST-08100K	KPS-FAST-08100K-A4	KPS-FAST-08100K-00	8.0 x 100	6.0 x 105	30*/50**	TX-30	SW-10	50
	KPS-FAST-08120K	KPS-FAST-08120K-A4	KPS-FAST-08120K-00	8.0 x 120	6.0 x 125	50*/70**	TX-30	SW-10	50
	KPS-FAST-08140K	KPS-FAST-08140K-A4	KPS-FAST-08140K-00	8.0 x 140	6.0 x 145	70*/90**	TX-30	SW-10	50

### TECHNICAL DATA

Parameter	Unit	Value
Plug diameter	$d_k$ [mm]	8
Hole/drill diameter	$d_o$ [mm]	8
Effective anchorage depth	$h_{eff}$ [mm]	70*/50**
Depth of drill hole	$h_o$ [mm]	80*/60**
Drive type	x	TX-30/SW-10
Use categories	x	A B C D
Sleeve material	x	PA
Screw material	x	A4, hot-dip galvanized, steel
Approval	x	ETA-12/0272

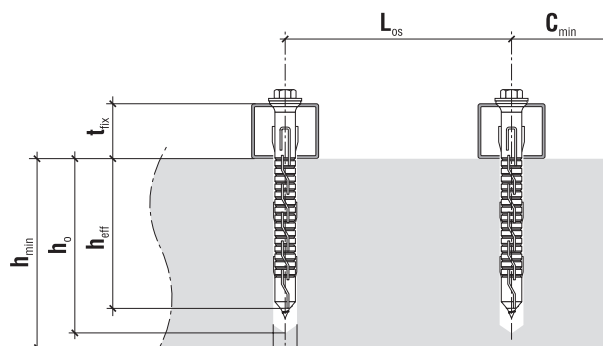

### SUBSTRATE - MINIMUM THICKNESS, DISTANCE

Substrate	Min. member thickness $h_{min}$ [mm]	Min. edge distance $c_{min}$ [mm]
Concrete C20/25	100	60*/50**
Solid clay brick	120	100
Solid sand-lime brick	120	100
Perforated clay brick	180	100
Autoclaved aerated concrete	100	100

\* for standard anchorage depth, use category A, B, C, D

\*\* for reduced anchorage depth, use category A, B



From now all our framework fasteners Fast and Strong are **PRE-ASSEMBLED**.

**Pre-assembled products means:**

- ✓ easier and faster mounting
- ✓ no wasting time for assembling
- ✓ no mistake in choosing sleeve to the screw