

LG Heavy duty plate tie

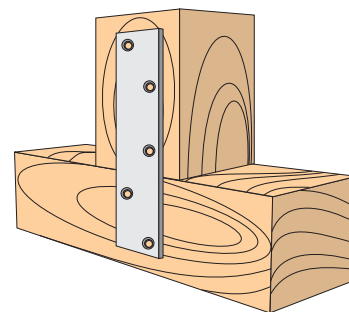

DIN-EN 14545:2009

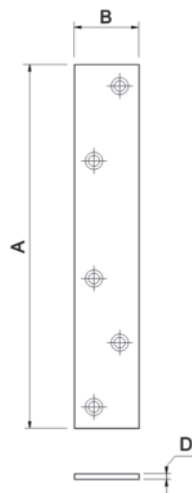

Description

Nail plates are designed to be used for timber connections. Can be made with the following fasteners: nails, screws, ring shank nails and screws. Material: steel sheet. Corrosion protection: zinc plated. Fire resistance class A1

Code	Dimensions [mm]			No. of holes		Pcs
	A	B	D	ø5.0	ø7.0	
LG-01(X50)	170	30	2.5	5	-	50
LG-02(X50)	195	35	4	-	7	50

LT T brackets



DIN-EN 14545:2009

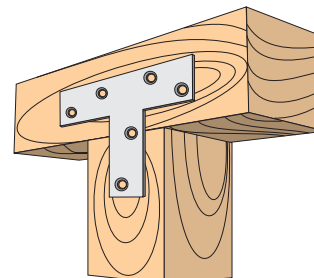
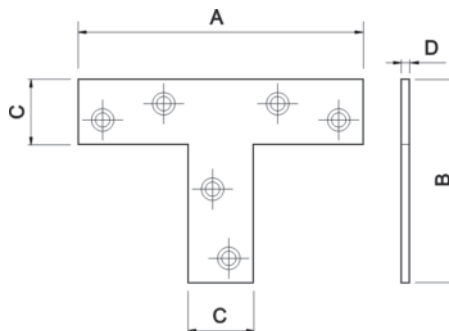

Description

Nail plates are designed to be used for timber connections. Can be made with the following fasteners: nails, screws, ring shank nails and screws. Material: steel sheet. Corrosion protection: zinc plated. Fire resistance class A1

Code	Dimensions [mm]				No. of holes	Pcs
	A	B	C	D		
LT-01(X50)	70	50	16	2	ø8.0	50