

**POD** (DIN 9021A, ISO 7093-1) **Wide flat washers**

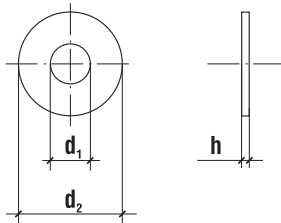
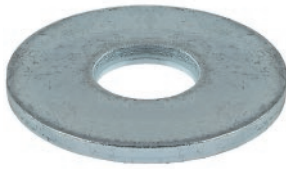

Description

**Application** 200HV washers for use with:  
- A and B grade bolts, strength class up to 8.8 inclusive,  
- A and B grade hex nuts, strength class up to 8,  
- hardened bolts.

**Material** Zinc-plated low carbon steel.  
Class of precision of execution: A.

	Code	d <sub>1</sub>	d <sub>2</sub>	h	
<b>M5</b>	POD-05	5,3	15	1,0	4
<b>M6</b>	POD-06	6,4	18	1,6	4
<b>M8</b>	POD-08	8,4	24	2,0	4
<b>M10</b>	POD-10	10,5	30	2,5	4
<b>M12</b>	POD-12	13	37	3,0	4
<b>M14</b>	POD-14	15	44	3,0	4
<b>M16</b>	POD-16	17	50	3,0	4
<b>M20</b>	POD-20	21	60	4,0	4
<b>M24</b>	POD-24	25	70	4,0	4

**POS** (DIN 127,PN 82008) **Spring washers**

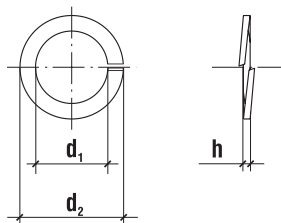

Description

**Application** 200HV washers for use with:  
- A and B grade bolts, strength class up to 8.8 inclusive,  
- A and B grade hex nuts, strength class up to 8,  
- hardened bolts.

**Material** Zinc-plated low carbon steel.  
Class of precision of execution: A.

	Code	d <sub>1</sub>	d <sub>2</sub>	h	
<b>M5</b>	POD-05	5,3	10	1,0	3
<b>M6</b>	POD-06	6,4	12	1,6	3
<b>M8</b>	POD-08	8,4	16	1,6	3
<b>M10</b>	POD-10	10,5	20	2,0	3
<b>M12</b>	POD-12	13	24	2,5	3
<b>M14</b>	POD-14	15	28	2,5	3
<b>M16</b>	POD-16	17	30	3,0	3
<b>M20</b>	POD-20	21	37	3,0	3