

SMK Hammer drive plug with collar Ø6 **POLYPROPYLENE**

SMNK Hammer drive plug with collar Ø6 **NYLON**



AT-15-9031/2012



Description

Plug with collar for fixing of metal members

Technical data

Type of installation push-through installation

Substrate concrete, solid clay brick, calcium silicate brick, autoclaved aerated concrete

Sleeve material/protective coating

PP polypropylene	100% nylon	Blue zinc
---------------------	---------------	--------------

Features and advantages of the product



Better holding power

Increased head diameter ensures much better holding power of the elements being installed.



Secure fixing

Countersunk head is more solid with special underhead strengthening.



Installation

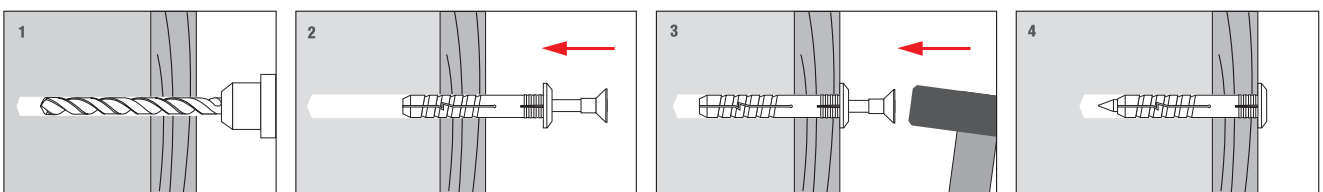

TECHNICAL DATA

Product marking

SMNK	06	040
Type	Diameter	Length

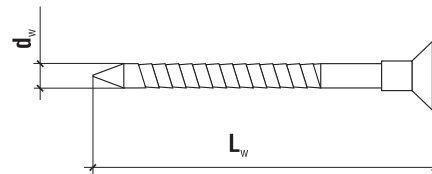
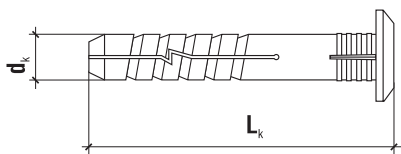

PZ-2

Ø6	Code	Code	$d_k \times L_k$ [mm]	$d_w \times L_w$ [mm]	Max. fixture thickness t_{fix} [mm]	PZ	Pcs
	POLYPROPYLENE	NYLON					
	SMK-06040	SMNK-06040	6 x 40	3.9 x 45	10	PZ 2	200
	SMK-06060	SMNK-06060	6 x 60	3.9 x 65	30	PZ 2	200
	SMK-06080	SMNK-06080	6 x 80	3.9 x 85	50	PZ 2	100

TECHNICAL DATA

Parameter	Unit	SMK	SMNK
Plug diameter	d_k [mm]	6	6
Hole diameter	d_o [mm]	6	6
Effective anchorage depth	h_{eff} [mm]	30	30
Depth of drill hole	h_o [mm]	40	40
Sleeve material	x	PP	PA
Screw material	x	Zinc plated steel	Zinc plated steel
Approval	x	AT-15-9031/2012	AT-15-9031/2012

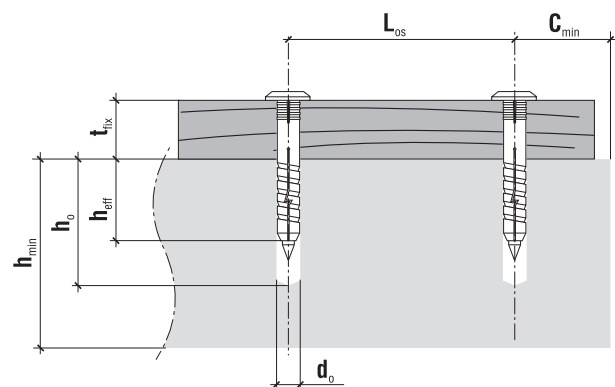

DESIGN PULL-OUT RESISTANCE [kN]

Substrate	SMK-6	SMNK-6
Concrete C20/25	0.23	0.67
Solid clay brick	0.18	0.30
Calcium silicate brick	0.32	0.42
Autoclaved aerated concrete	0.13	0.11

SUBSTRATE, MINIMUM THICKNESS, DISTANCE

Plug type	Min. member thickness h_{min} [mm]	Min. edge distance c_{min} [mm]	Min. spacing L_{os} [mm]
SMK-6/SMNK-6	60	30	60

